

BOX CONTENTS

COMPONENTS

- 1.1 Ceiling plate - Class G
- 2.2 Top pivot 70 mm - Class G
- 3.2 Bottom pivot System One 70 mm
- 4.3 Floor plate - Squared black

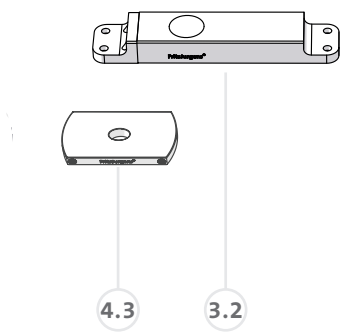
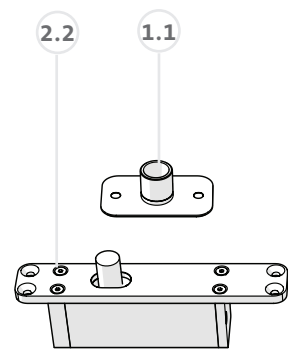

MILLING AND MOUNTING KIT

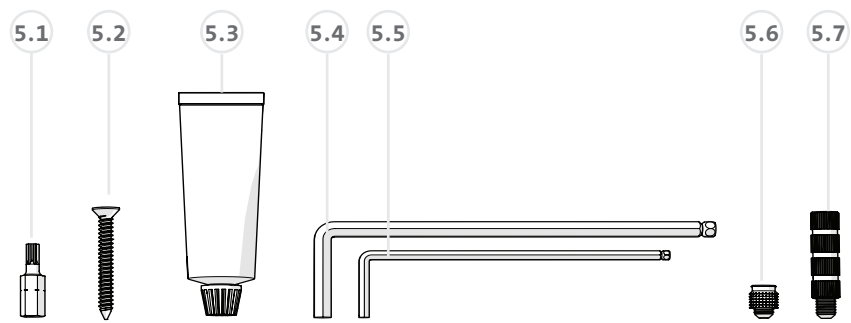

- 5.1 Torx bit TX20 (1x)
- 5.2 Screws (Ø4x50) (10x)
- 5.3 Fitting adhesive
- 5.4 Allen key 5
- 5.5 Allen key 3
- 5.6 Mounting pins, short* (2x)
- 5.7 Mounting pins, long* (2x)
- 5.8 Drilling template

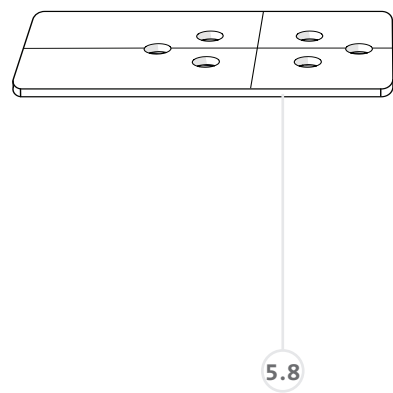

SYSTEM OVERVIEW

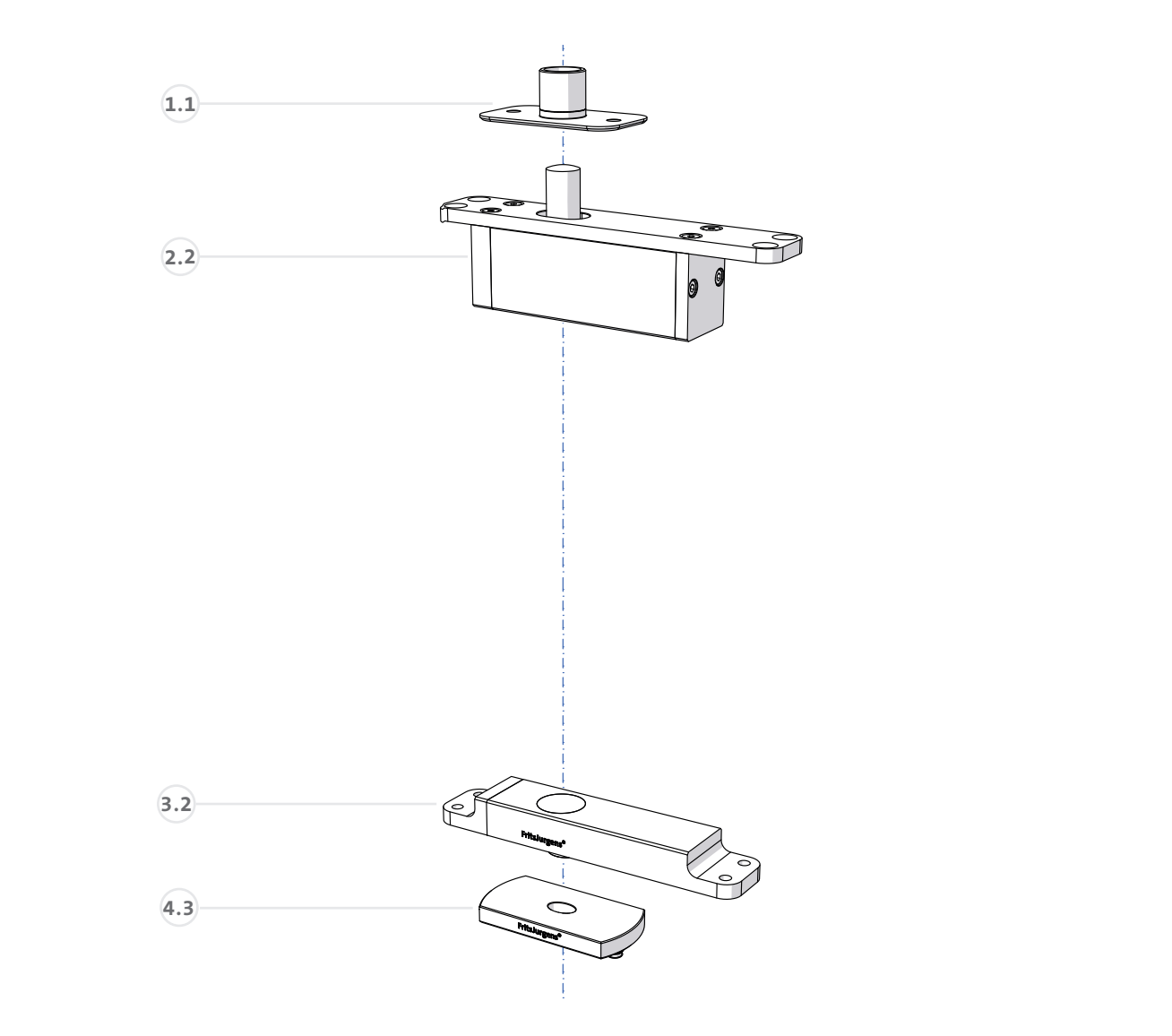

MILLING INSTRUCTIONS

→ Determine pivot point **A**.

- System One**
- **A** = 40 mm
 - 70 mm ≤ **A** ≤ 250 mm

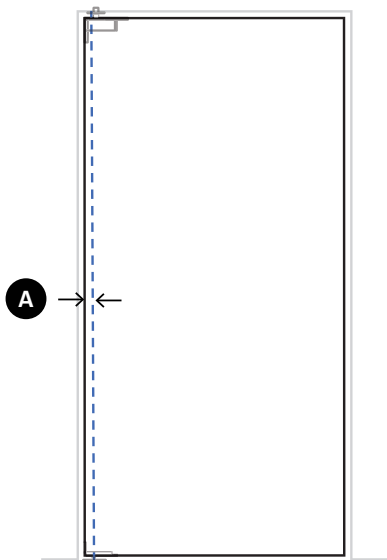

MOUNTING INSTRUCTION

- 1

Determine the position of pivot point **A** on the floor. Use the drilling template and the table below.
- 2

Mark pivot point **A** on the floor and on the ceiling.

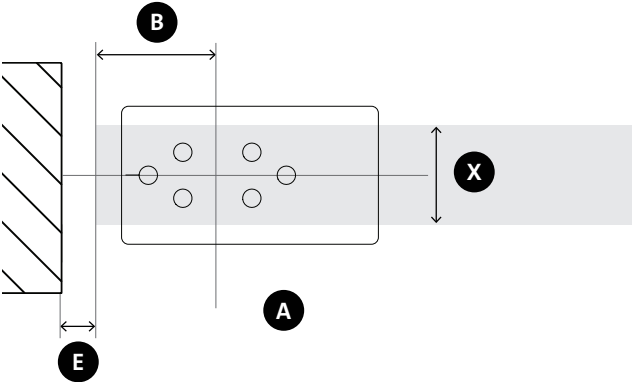

	40	X
B		
40	2	
70	5	
91	4	
250	3	
500	2	
1000	2	
1500	2	
2000	2	E

- E

Minimum gap between door and wall (mm)
- B

Distance pivot point to door edge (mm)
- X

Door thickness (mm)

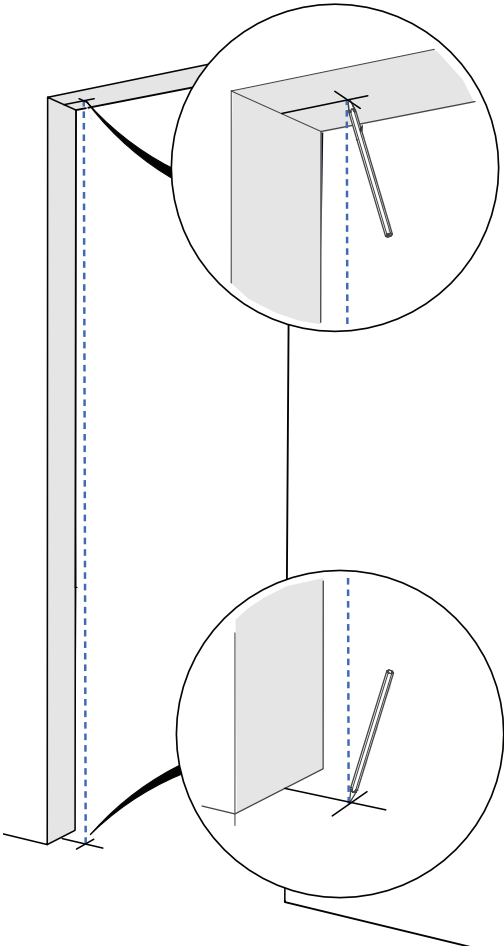

- 3

Mark the drilling holes on the floor. Use the drilling template.

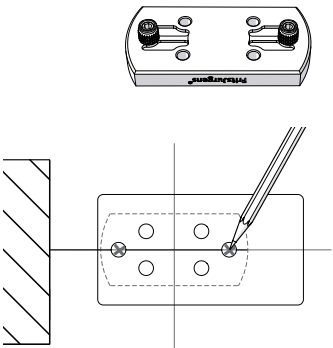

Floor plate squared NA or squared black, one floor type

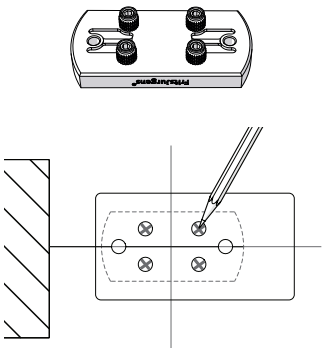

Floor plate squared NA or squared black, one or two floor types

- 4 Select the correct drill bit for the floor and determine the drilling depth.

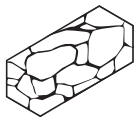

Ø8 mm
(5/16")

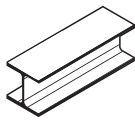

Ø8 mm
(5/16")

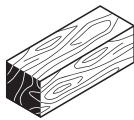

Ø7.5 mm
(19/64")

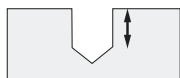

8 mm
(5/16")

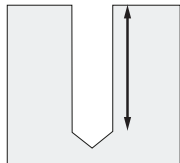

30 mm
(1 3/16")

- 6 Determine the pin configuration for your situation. If necessary, use Allen key 3 to unmount the pre-installed pins and install the correct configuration.

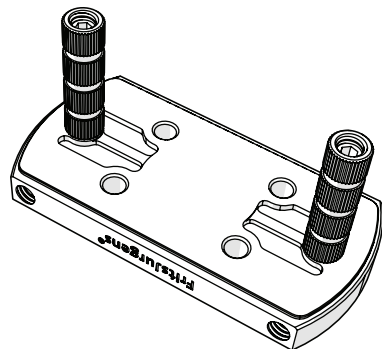
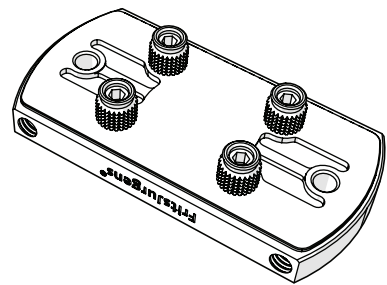
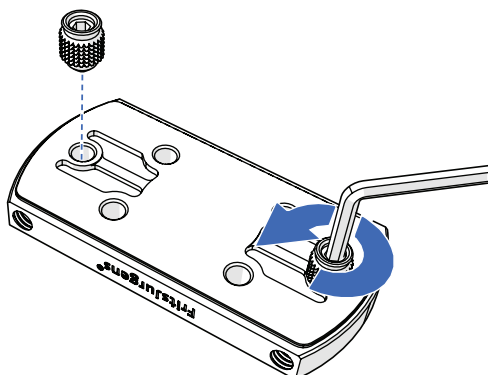

- 5 Drill the holes in the floor on the marked spots.

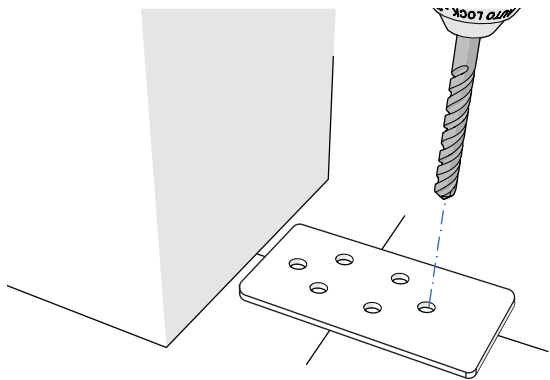

MOUNTING

- 7 Fill the glue chambers in the floor plate with glue and apply a 1 mm layer of glue in between the chambers.

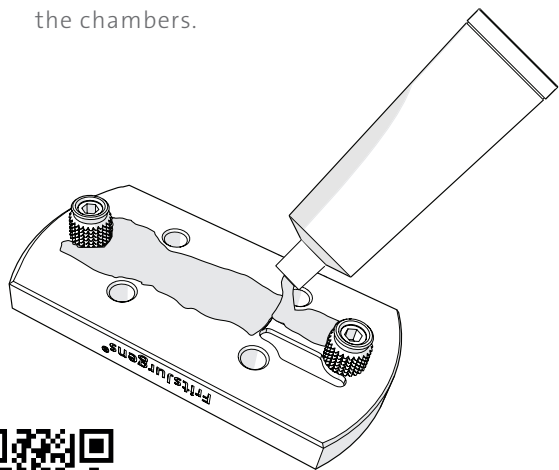

* Scan the QR code for information about drying time and glue specifications.

- 9 Use a rubber hammer to affix the floor plate.

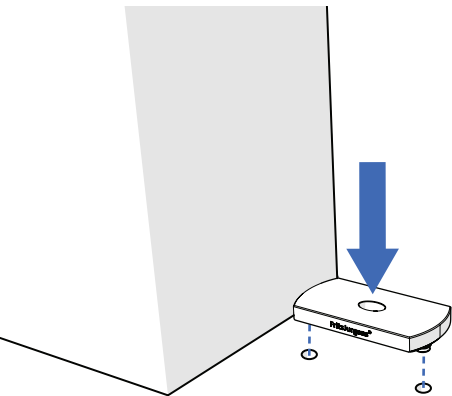

- 8 Add glue in the holes in the floor. Make sure the holes don't overflow when you place the floor plate.

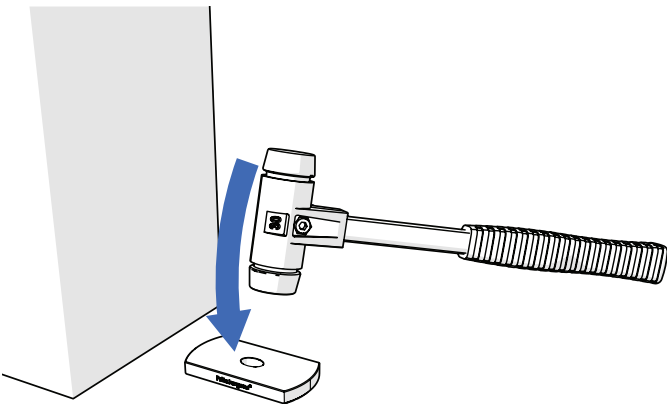
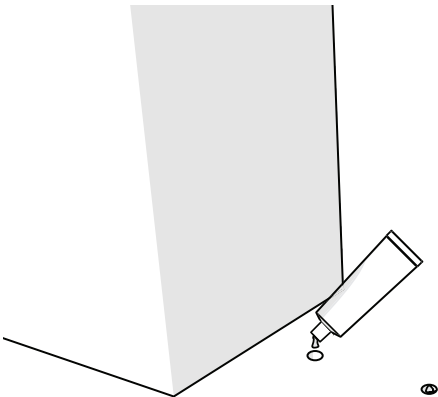

CEILING PLATE

1 Drill a hole for the ceiling plate.

ceiling plate
Class G

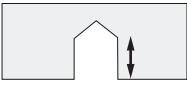

20 mm
(25/32")

Ø20 mm
(25/32")

ceiling plate
Cable
Grommet



Ø20 mm
(25/32")

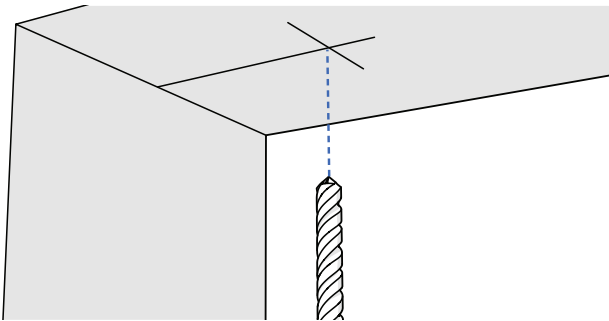

2 Apply a 1 mm thick layer of glue to the ceiling plate.

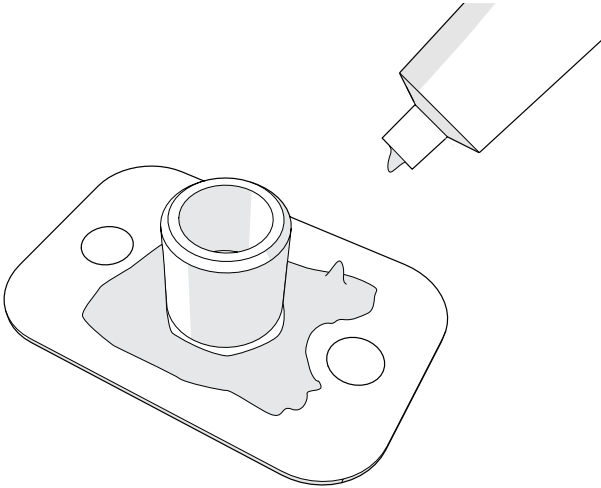

3 Affix the ceiling plate.

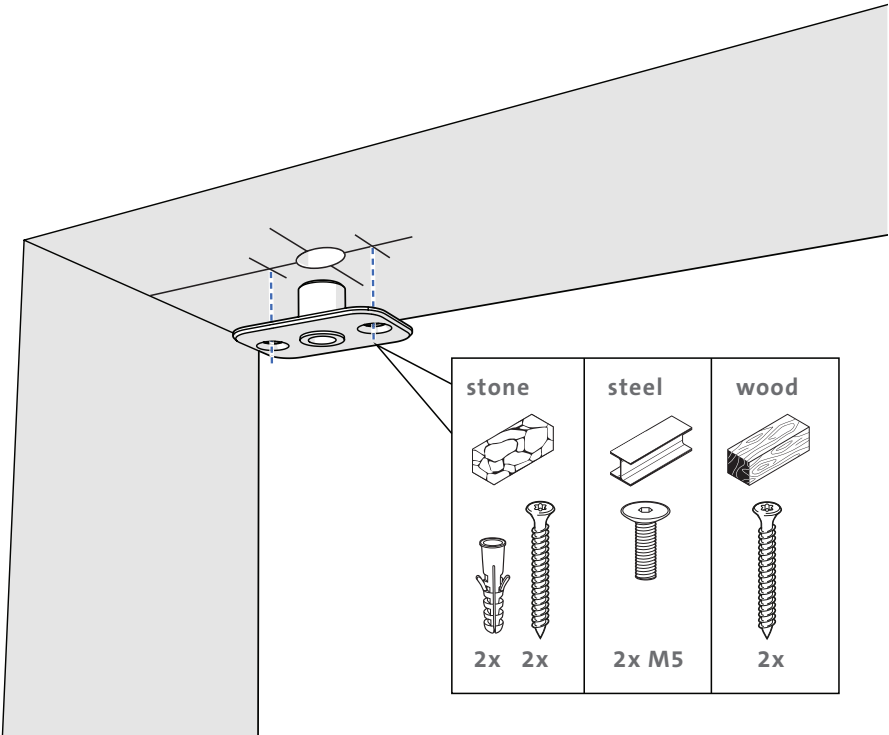

MOUNTING

DOOR

- 1

Position the door on the floor plate. Make sure the bottom cam is positioned in the elliptical hole in the floor plate. Align the door with the ceiling plate.
- 2

Extend the pivot with Allen key 5 or use the Hexagon Guide (page 8, item 6.2).

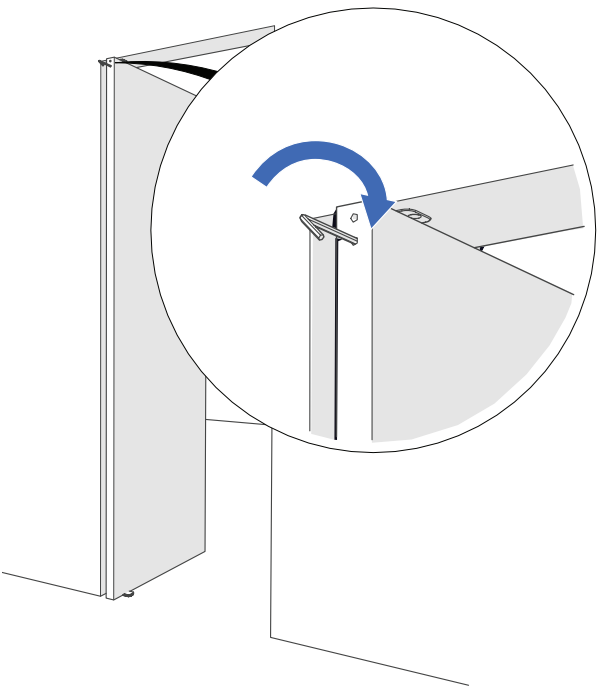
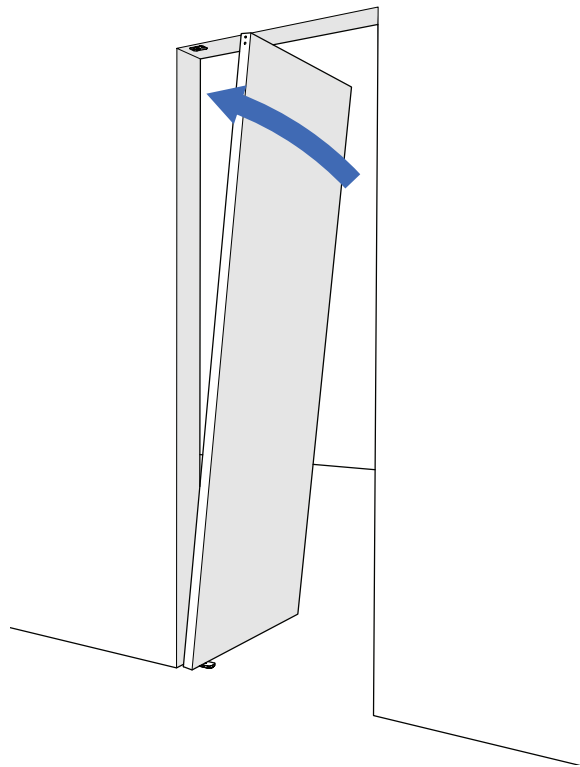

Top pivot 70 mm → Turn the key **8** times.

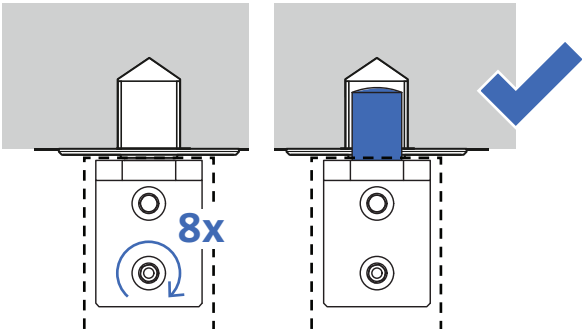

SIDE PLACEMENT AND MIDDLE PLACEMENT

FINE-TUNING THE CLOSING SEAM

- 1 Check if the door is aligned parallel to the ceiling and the wall.

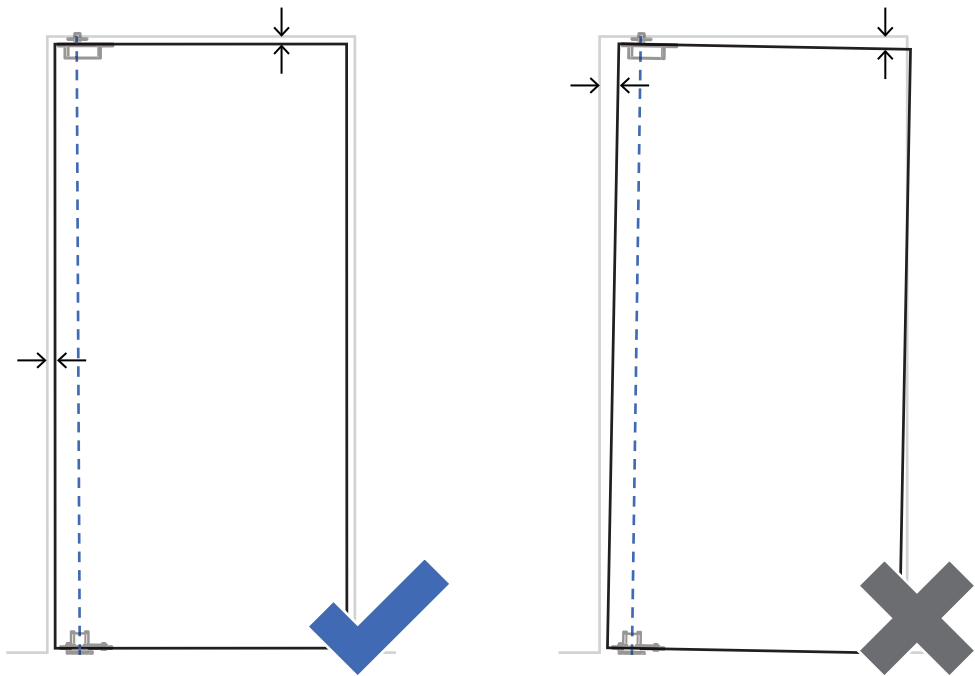

- 2 Open the door. Use Allen key 5 or the key of the Hexagon Guide (page 8, item 6.2) until the door is aligned parallel to the ceiling and the wall.

