

Moving Details.

# GLASS DOOR FITTINGS





## Moving solutions. Living spaces with glass.

With our passion for the material glass we create something really big from something small. Pure dynamics develop from perfectly coordinated, technically precise glass fittings.

Because it is the small elements with a big effect that make the movement of glass between rooms possible in the first place.

That is our self-conception. And we are committed to this with all our knowledge of the possibilities of glass in moving solutions.

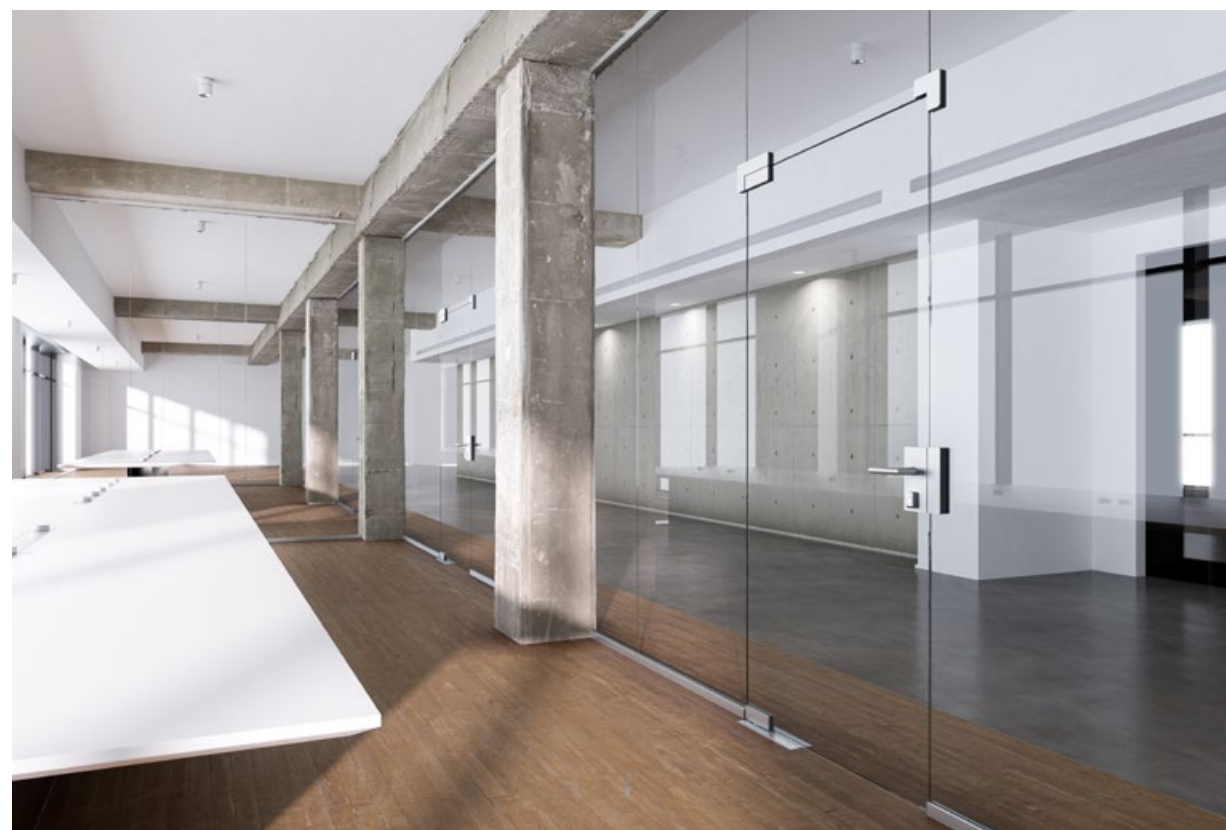

### Classic values

The STUDIO Classic fittings represent straight design, elegance and functionality.

### OFFICE Mundus

Well considered design, coherent across applications.



## Glass door fittings

Discreetly understated or as a representative design element. Whether for single-action doors in frames or for double-action doors, single or double-leaf. The versatile range of fittings always offers the right solution.

Doors and walls made of glass require special attention. That's why we have developed an extensive series of glass door fittings for single-action and double-action doors, diverse in form and matched to the desired function. By connecting the different hinge types with lock-lever combinations or handle bars, individual solutions can be realized, even for double panel doors.



### OFFICE Junior

Suitable for high frequency private and public spaces.





◀ **Cap design Made in Germany:**  
Exceptional design in our proven surfaces or in your colour of preference.

## STUDIO 1121

### Exclusive, modern and elegant

The milling of the lock caps out of solid aluminium allows finely worked out radii and defined edges. The remaining material thickness visibly shows the special value of the fitting. Equally high-quality, the powder coating of the lever handle, lock and hinge surfaces not only flatters the eye, but also the sense of touch – a good feeling with every contact.

#### Your advantages:

- Whisper-comfort noise reduction for quiet door closing
- Various handle positions
- Spring-supported clamp nut for exact handle positioning
- Existing frames can be used
- Long lifetime - 200,000 motion cycles of the latch function and the bolt were tested
- According to EN 12209

Find more information  
and documents here.



◀ **Classic values**  
The STUDIO Classic fittings represent straight design, elegance and functionality.

## STUDIO Classic

### A modern classic in a linear design

An open atmosphere, even when the door is closed. The slimline STUDIO Classic fitting emphasises the generous transparency of the glass door.

#### Your advantages:

- Whisper-comfort noise reduction for quiet door closing
- Chooseable handle position
- Spring-supported clamp nut for exact handle positioning
- Existing frames can be used
- Long lifetime – 200,000 motion cycles of the latch function and the bolt were tested
- According to EN 12209

Find more information  
and documents here.





◀ **STUDIO Rondo**  
The locks match with STUDIO Rondo hinges as well as with the strong Office Junior hinges.

## STUDIO Rondo

### The evergreen in a rounded design

Provide room for ideas and set highlights. The diverse handle and surface options for this fitting allow you to create individuality in your rooms. STUDIO Rondo has proven itself many times.

#### Your advantages:

- Whisper-comfort noise reduction for quiet door closing
- Chooseable handle position
- Spring-supported clamp nut for exact handle positioning
- Existing frames can be used
- Long lifetime – 200,000 motion cycles of the latch function and the bolt were tested
- According to EN 12209

Find more information  
and documents here.



◀ **STUDIO Gala 2.0**  
is available in versatile locking variants. At unlockable latch locks the lever handle can be positioned in the front or back.

## STUDIO Gala 2.0

### Distinctive with a dynamic line

STUDIO Gala 2.0 emphasizes striking features with its dynamic line as well as the high standard of an interior design with glass.

#### Your advantages:

- Whisper-comfort noise reduction for quiet door closing
- Chooseable handle position
- Spring-supported clamp nut for exact handle positioning
- Existing frames can be used
- Long lifetime – 200,000 motion cycles of the latch function and the bolt were tested
- According to EN 12209

Find more information  
and documents here.





◀ **STUDIO Medio**  
It is often the little things that make life more beautiful. This certainly applies to STUDIO Medio.

## STUDIO Medio

### Small shape, large effect

The delicate STUDIO Medio lock integrates harmoniously into the overall appearance of any door. The linear, discreet shape blends in perfectly with the glass design and does not affect the overall appearance.

#### Your advantages:

- Can be combined with hinges of your choice
- Existing frames can be used
- High quality materials

Find more information  
and documents here.



◀ **STUDIO Arcos**  
Lock, hinges and lever handle showing the arch shape typical for Arcos.

## STUDIO Arcos

### Bold in an arched design

STUDIO Arcos provides room for ideas and consciously emphasizes features. Regardless of the surface finish: The lock with the patented design impresses with its special arched shape. The appearance is particularly attractive when the lock is combined with the matching Arcos lever handle.

#### Your advantages:

- Whisper-comfort noise reduction for quiet door closing
- Chooseable handle position
- Spring-supported clamp nut for exact handle positioning
- Existing frames can be used
- Long lifetime – 200,000 motion cycles of the latch function and the bolt were tested
- According to EN 12209

Find more information  
and documents here.







◀ **Powerful sign**  
The Arcos design also convinces at the OFFICE locks and hinges.

## OFFICE Arcos

### Robust technology in an arched design

The Arcos design is also convincing for the OFFICE locks and hinges. Together with the matching Arcos lever handle, they form a visual unit. Reliable and robust, OFFICE Arcos withstands even heavier uses in every day life.

#### Your advantages:

- Reliable during heavy use
- Long lifetime due to high-quality materials
- Whisper-comfort noise reduction for quiet door closing
- 500,000 motion cycles of the latch function and 100,000 motion cycles of the bolt were successfully tested by a neutral testing institute
- According to EN 12209

Find more information  
and documents here.



◀ **OFFICE Classic**  
Built for high endurance.

## OFFICE Classic

### Straight and solid

Designed for everyday use but not ordinary: The timeless modern fittings for single-action doors are available in different variations that emphasize visual features with their linearity. They are designed without compromises for heavy-duty use. Thus, they are ideal for highly frequented doors.

#### Your advantages:

- Reliable during heavy use
- Long lifetime due to high-quality materials
- Whisper-comfort noise reduction for quiet door closing
- 500,000 motion cycles of the latch function and 100,000 motion cycles of the bolt were successfully tested by a neutral testing institute
- According to EN 12209- According to EN 12209

Find more information  
and documents here.





◀ **OFFICE Junior**  
Suitable for high  
frequency private  
and public spaces.

## OFFICE Junior

### Timeless, for heavy use

Timeless design, so versatile and reliable in its function: The OFFICE Junior fitting system has been designed for heavy use and a long lifetime. With a variety of surface designs and locking options as well as matching lever handles it is a reliable choice for both residential and commercial buildings.

#### Your advantages:

- Reliable during heavy use
- Long lifetime due to high-quality materials
- Whisper-comfort noise reduction for quiet door closing
- 500,000 motion cycles of the latch function and 100,000 motion cycles of the bolt were successfully tested by a neutral testing institute
- According to EN 12209

Find more information  
and documents here.



▶ **OFFICE Mundus**  
Well considered  
design, coherent  
across applications.

## OFFICE Mundus

### Clear lines, selected materials

On a single door in a frame with hinges, the OFFICE Mundus lock stands out with its special, angular shape. And it is even more convincing in toughened glass assemblies in combination with the matching MUNDUS corner fittings. The dark plastic frame emphasises the decorative surfaces made of aluminium or stainless steel.

#### Your advantages:

- Reliable during heavy use
- Long lifetime due to high-quality materials
- Whisper-comfort noise reduction for quiet door closing
- 500,000 motion cycles of the latch function and 100,000 motion cycles of the bolt were successfully tested by a neutral testing institute
- According to EN 12209

Find more information  
and documents here.







**MARCATO Motion**  
 Closing speed (re)  
 adjustable at any time.

## MARCATO Motion

### Double-action door with speed-control

Two together can do more than one alone. And if the respective strengths are balanced, then two will become one again. Like MARCATO Motion. Each double-action door, whether as a single glass door or connected to a glass side panel, is installed here with two strong fittings. The individual functions „close“ and „control“ ensure that the door equipped in this way is gently closed to the zero position at an adjustable speed from both open directions.

#### Your advantages:

- Hydraulic closing function (starting at 70° opening angle) without additional functional elements
- Closing speed (re)adjustable at any time
- Hold open at 90° opening angle
- Wall mounting or for connection to a glass side panel.

Find more information  
and documents here.



**RP**  
 As an alternative to  
 UNIVERSAL patch  
 fittings, the double-  
 action door can also be  
 fitted with MUNDUS  
 patch fittings on  
 special request.

## RP

### Concealed door closer for double-action doors with patch fittings

The RP double-action door system works with a RTS frame door closer, which is concealed in a continuous frame profile. The door leaf is connected via a top and a bottom patch fitting.

#### Your advantages:

- The door automatically swings back into the zero-position
- Hold open at 90° opening angle
- Downward connection by screw-on floor bearing: valuable floor finishes (underfloor heating etc.) remain intact.

Find more information  
and documents here.





┌ We present DORMA-Glas products ┐



**DORMA-Glas GmbH**

Max-Planck-Straße 33-45

D - 32107 Bad Salzuflen

T +49 5222 924-0

[glasbeschlag@dorma-glas.com](mailto:glasbeschlag@dorma-glas.com)

[www.dorma-glas.com](http://www.dorma-glas.com)



WN 80051555632  
Subject to change without notice